

**IMPORTANT INFORMATION**  
 This drawing is the property of One Design Architectural Services Ltd. It is the property of the client and is to be used only for the purposes for which it is intended. It is not to be reproduced, stored in a retrieval system, or transmitted in any form or by any means, electronic, mechanical, photocopying, recording, or by any information storage and retrieval system, without the prior written permission of One Design Architectural Services Ltd. The client acknowledges that the design is for their information only and that they are responsible for ensuring that the design meets all applicable regulations and standards. The client also acknowledges that the design is for their information only and that they are responsible for ensuring that the design meets all applicable regulations and standards. The client also acknowledges that the design is for their information only and that they are responsible for ensuring that the design meets all applicable regulations and standards.

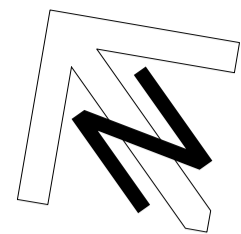

SCHEDULE	
Sales Area	1261 m <sup>2</sup>
Warehouse	577 m <sup>2</sup>
Ancillary	210 m <sup>2</sup>
Walls	32m <sup>2</sup>
Grand total:	2080 m <sup>2</sup>

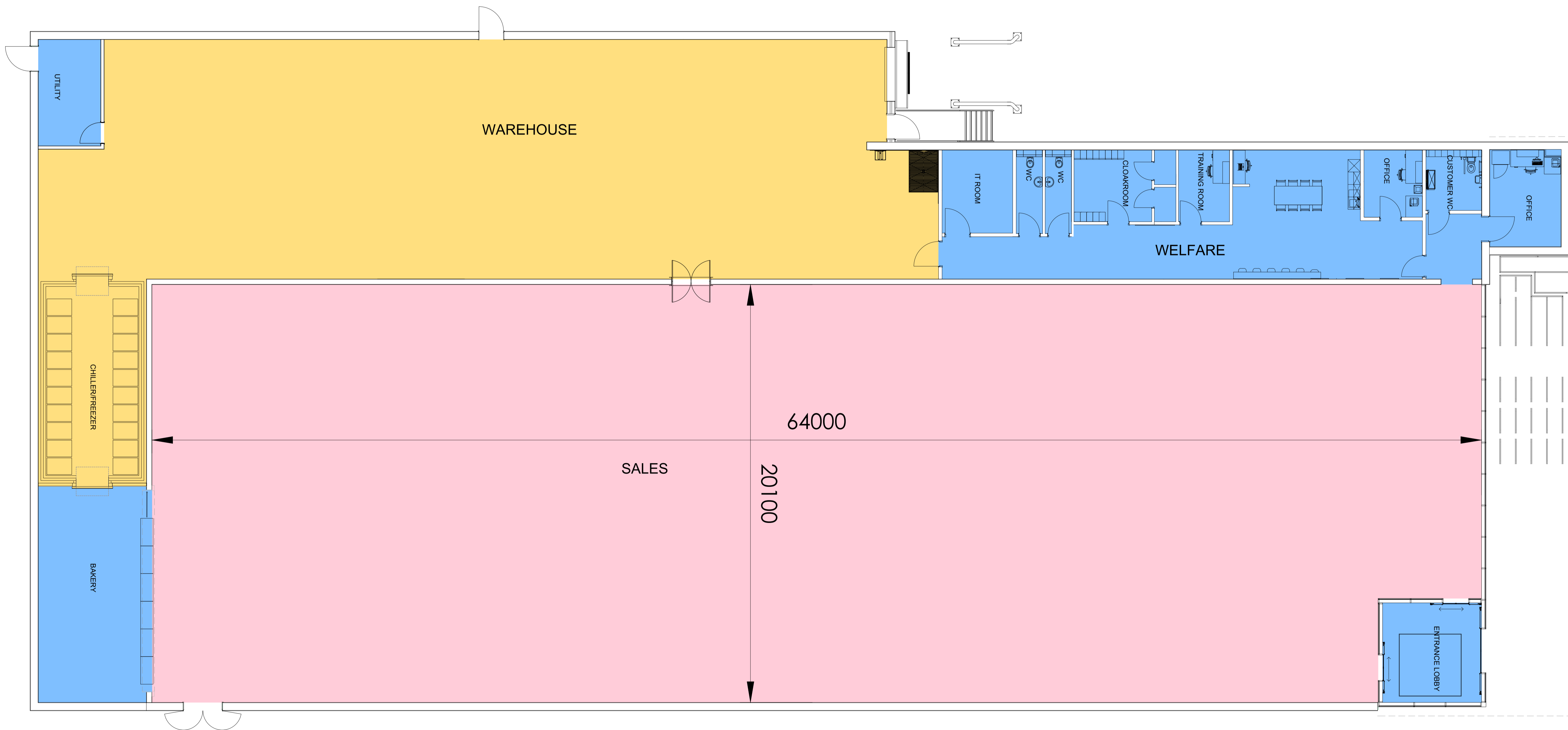

Rev: \_\_\_\_\_ Date: \_\_\_\_\_  
 Description: \_\_\_\_\_  
 Amendments: \_\_\_\_\_  
 Prepared/Checked by: \_\_\_\_\_

**STATUS: PLANNING**

**Client**  
 LIDL UK GMBH FOXES PARK, BROWN HILL WAY,  
 NURSING, SOUTHAMPTON, HAMPSHIRE, SO16 0AW

**Project**  
 FORMER CATTLE MARKET, CHRISTY'S LANE,  
 SHAFESBURY, SP7 8PH

**Title**  
 PROPOSED BUILDING PLAN

**Job No.** 17132  
**Drawing No.** AD 111  
**Drawn by** PAH  
**Checked by** LMC  
**Date** JAN 2019  
**Scale** 1:100  
**Sheet** A1

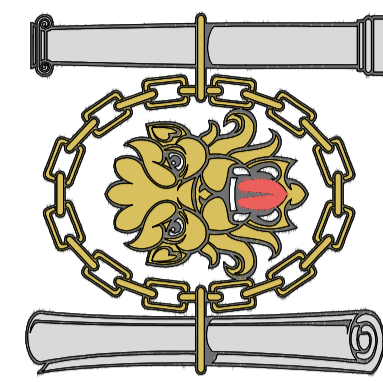

One Design Architectural Services Ltd  
 Unit 1, Merchants Quay,  
 Phase II, Ashley Lane, Shipley  
 West Yorkshire, BD17 7DB  
 0 1 2 7 4 5 9 1 1 8 8  
 www.onedesignarchitects.com  
 mail@onedesignarchitects.com